



Electrolux
PROFESSIONAL

Modular Preparation 1200 mm Drop-in Bowl with Right Drain

ITEM # _____

MODEL # _____

NAME # _____

SIS # _____

AIA # _____



855235 (TVI1200R)

Drop-in bowl (600x500) and
right-hand drainer

Short Form Specification

Item No. _____

Made from 304 AISI stainless steel. The 40mm high worktop is in 304 AISI stainless steel. Heavy duty splashback is 100mm high with a 45° top angle with welded sides and rear part covered by stainless steel profile. Bowl fully welded and with polished corners.

Bowl mm600x500x250h with overflow pipe and 70Ø drain hole; righthand drainer.

Main Features

- Extremely easy to clean thanks to the large and smooth seamless surface with Scotch-Brite finishing.

Construction

- 304 AISI stainless steel worktop (CrNi 18/10) 40 mm high, 15/10 (16 gauges) thickness.
- 100 mm boxed heavy duty splashback with a 45° degrees top angle, folded directly from the worktop, has fully welded sides and rear part completely covered by stainless steel profile to avoid water spillage on modules below.
- For a work height of 900 mm, worktops can be mounted on: solid bracket, solid bracket plus 50x50mm legs, 710 mm ambient, with hinged or sliding doors, placed on oversized (65x65mm) 150mm high feet (0/+90mm adjustable in height).
- 600x500x250 10/10 bowls.
- Bull-nose special shape front profile, without burrs, avoids water leakage on modules below.
- Fully welded and polished corners.

APPROVAL: _____



Experience the Excellence
www.electroluxprofessional.com
professional@electrolux.com



Electrolux
PROFESSIONAL

Modular Preparation 1200 mm Drop-in Bowl with Right Drain

Key Information:

External dimensions, Width:	
855235 (TVI1200R)	1160 mm
External dimensions, Depth:	550 mm
External dimensions, Height:	250 mm
Net weight:	2 kg

Front



Side

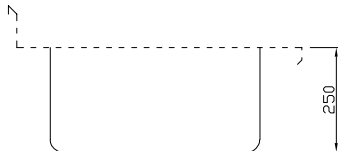

Top

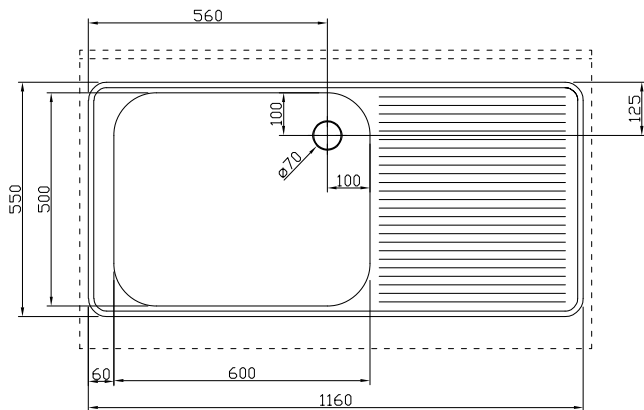

Modular Preparation
1200 mm Drop-in Bowl with Right Drain

The company reserves the right to make modifications to the products without prior notice. All information correct at time of printing.

2025.04.25